

THIS DRAWING IS THE PROPERTY OF PRIMARY FLUID SYSTEMS INC. FROM WHICH A WRITTEN CONSENT FOR APPROVAL SHALL BE REQUIRED PRIOR TO COPYING.

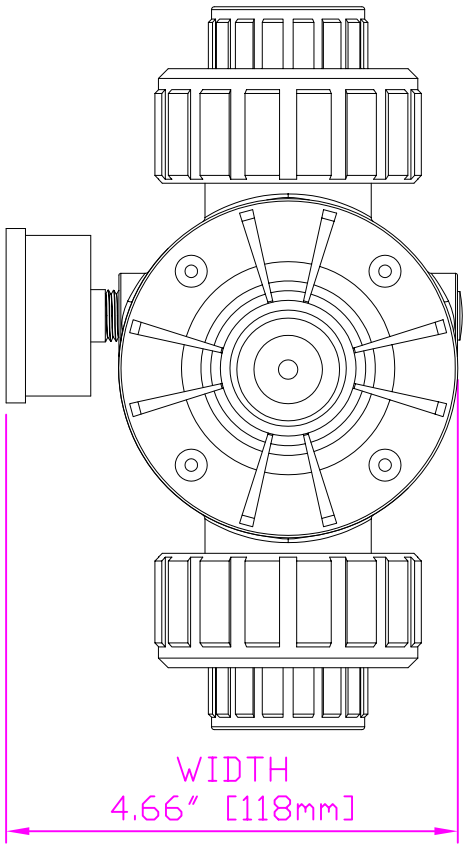

WIDTH
4.66" [118mm]

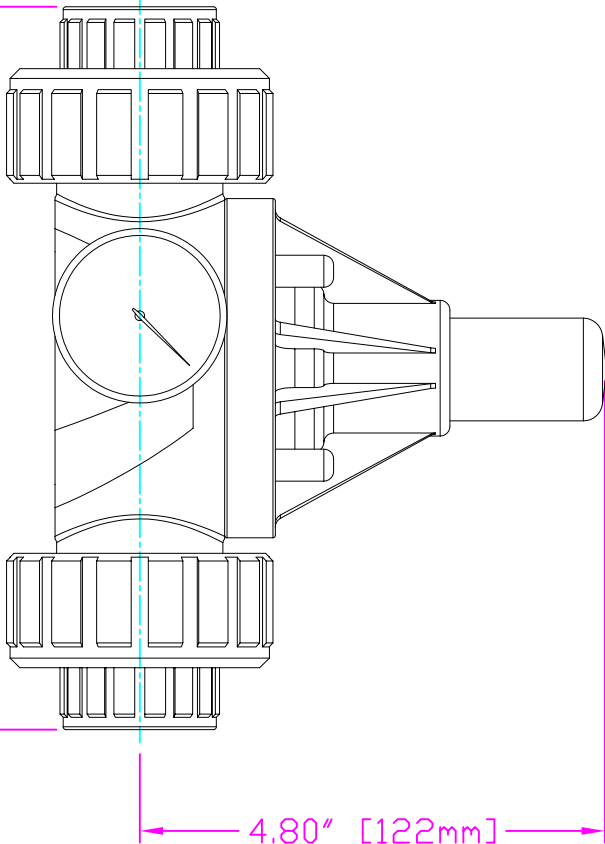

HEIGHT (H)
4.80" [122mm]

LENGTH (L)
7.30" [185mm]

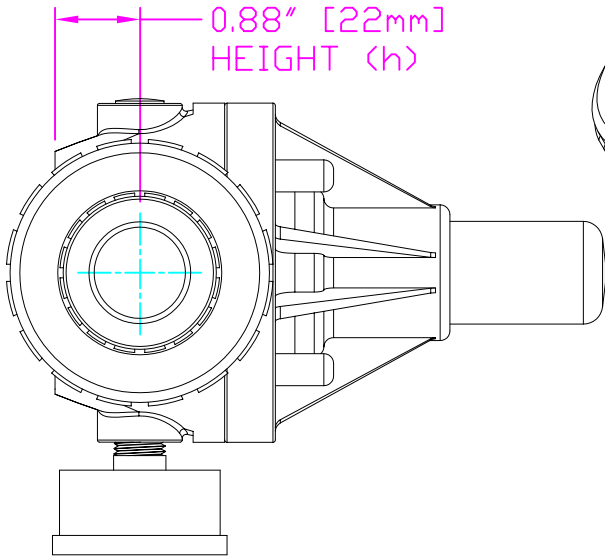
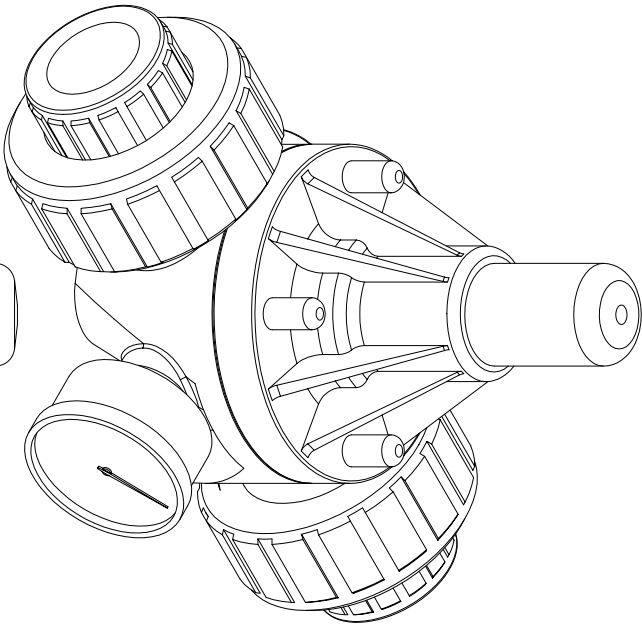

HEIGHT (h)
0.88" [22mm]

THIS DRAWING WITH DIMENSIONS
APPLY TO FOLLOWING MODELS:

- ECD-75I-PVC-P-GAUGE
- ECD-75I-CPVC-T-GAUGE
- ECD-75I-PP-T-GAUGE
- ECD-75I-PVDF-T-GAUGE
- ECD-75J-PVC-P-GAUGE
- ECD-75J-CPVC-T-GAUGE
- ECD-75J-PP-T-GAUGE
- ECD-75J-PVDF-T-GAUGE

PRIMARY FLUID SYSTEMS INC.

1050 Cooke Blvd., Burlington, Ontario L7T 4A8

UNION X 3/4" (DN 20) SOCKETED
ECD VALVE
WITH GAUGE

PROJECT: B-SERIES ECD		SHT. 1 OF 1	DRAWN BY: VICTOR W.
DATE ISSUED: 17-AUG-10		SCALE: 1/2"	UNITS: INCHES
ECD-75I-PVC-P-GAUGE-2D			REV.#: 1
MATERIAL: POLY			
APPROVED BY:			
THIRD ANGLE PROJECTION			
DIMENSIONAL TOLERANCE XXX = ± 0.25"			
SHEET SIZE: 8.5 X 11			
A			