

Technical drawing of a valve, showing a side view. The drawing includes a dimension line indicating the width of the valve body, which is 4.66" [118mm]. The valve body is circular with a central opening and several radial slots. The drawing is labeled with 'WIDTH' and the dimension '4.66" [118mm]'.

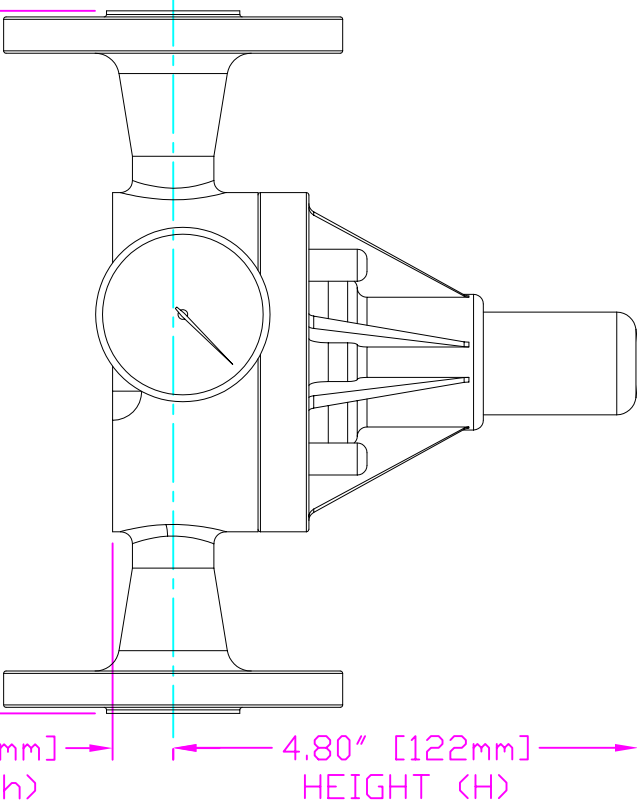

WIDTH
4.66" [118mm]

0.63" [16mm] → | ← 4.80" [122mm]
HEIGHT (h) HEIGHT (H)

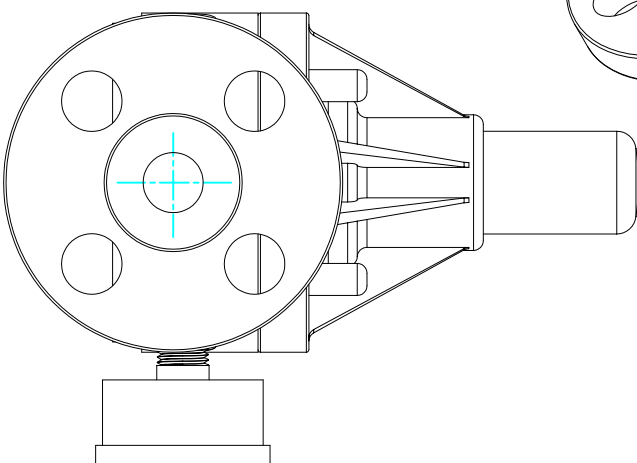

PRIMARY FLUID SYSTEMS INC.

1050 Cooke Blvd., Burlington, Ontario L7T 4A8

**1/2" (DN 15) FLANGED
ECD VALVE (HI FLOW VERSION)
WITH GAUGE**

DWG TYPE:

PLANAR VIEW 2-D

PROJECT: B-SERIES ECD	SHT: 1 OF 1	DRAWN BY: VICTOR W.
DATE ISSUED: 26-AUG-10	SCALE: 1/2	UNITS: INCHES

DWG NO.:

ECD-55E-SS-T-GAUGE-2D

MATERIAL: METALLIC

APPROVED BY:



DIMENSIONAL TOLERANCE
X.XX = ± 0.25'

REV.#:
1

A