

THIS DRAWING IS THE PROPERTY OF PRIMARY FLUID SYSTEMS INC. FROM WHICH A WRITTEN CONSENT FOR APPROVAL SHALL BE REQUIRED PRIOR TO COPYING.

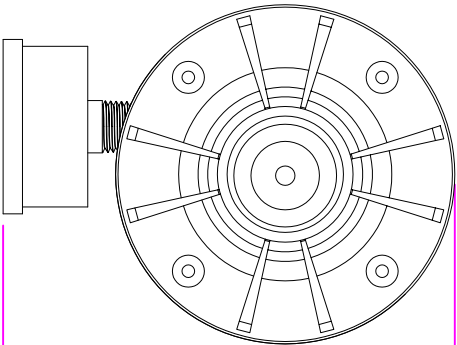

WIDTH
4.66" [118mm]

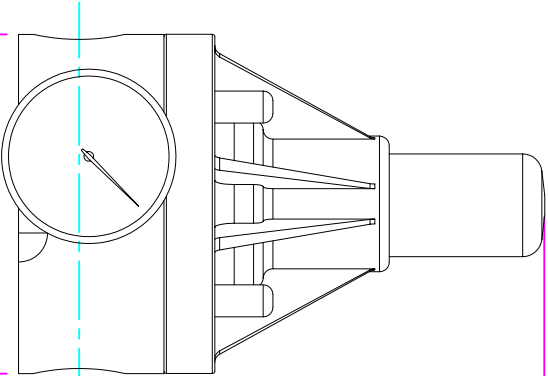

LENGTH (L)
3.50" [89mm]

HEIGHT (H)
4.80" [122mm]

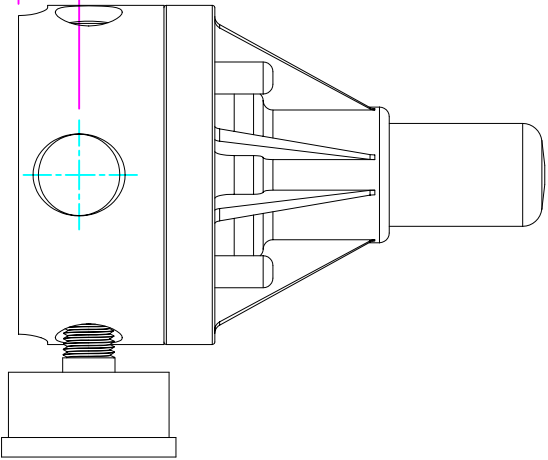
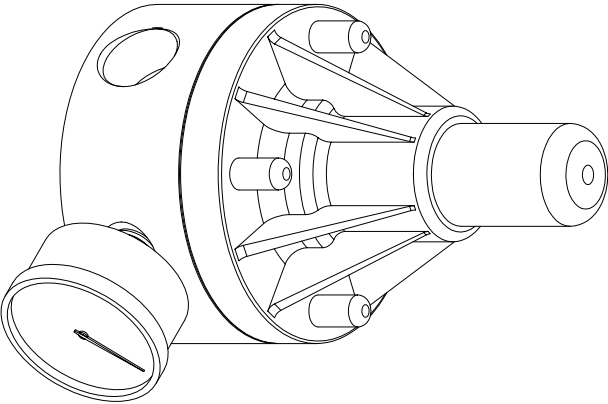

HEIGHT (h)
0.63" [16mm]

THIS DRAWING WITH DIMENSIONS
APPLY TO FOLLOWING MODELS:

- ECD-SSC-ALL20-T-GAUGE
- ECD-SSC-HAST-T-GAUGE
- ECD-SSC-SS-T-GAUGE
- ECD-SSD-ALL20-T-GAUGE
- ECD-SSD-HAST-T-GAUGE
- ECD-SSD-SS-T-GAUGE

PRIMARY FLUID SYSTEMS INC.

1050 Cooke Blvd., Burlington, Ontario L7T 4A8

TITLE:

1/2" (DN 15) SOCKETED
ECD VALVE (HI FLOW VERSION)
WITH GAUGE

DWG TYPE:

PLANAR VIEW 2-D

PROJECT: B-SERIES ECD

DATE ISSUED: 26-AUG-10

DWG NO: ECD-SSC-SS-T-GAUGE-2D

MATERIAL: METALLIC

APPROVED BY:

DIMENSIONAL TOLERANCE
XXX = ± 0.25"

REV# 1

DRAWN BY: VICTOR W.L.

SCALE: 1:2

SHT: 1 OF 1

UNITS: INCHES

INDICATED PROJECTION

6.5 X 11

SHEET

SIZE: A