

THIS DRAWING IS THE PROPERTY OF PRIMARY FLUID SYSTEMS INC. FROM WHICH A WRITTEN CONSENT FOR APPROVAL SHALL BE REQUIRED PRIOR TO COPYING.

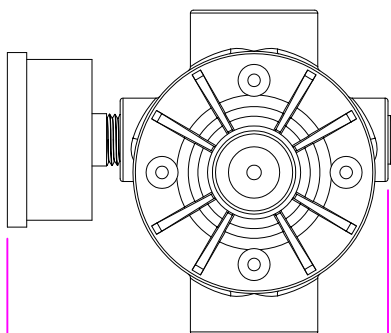

3.93" [100mm]  
WIDTH

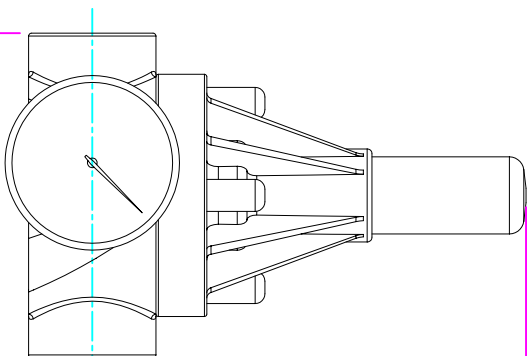

LENGTH (L)  
3.40" [86mm]

4.48" [114mm]  
HEIGHT (H)

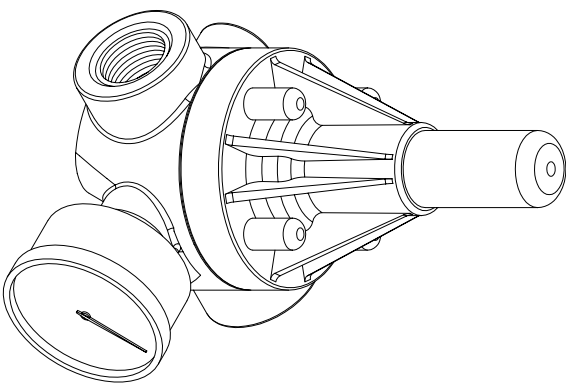

0.66" [17mm]  
HEIGHT (h)

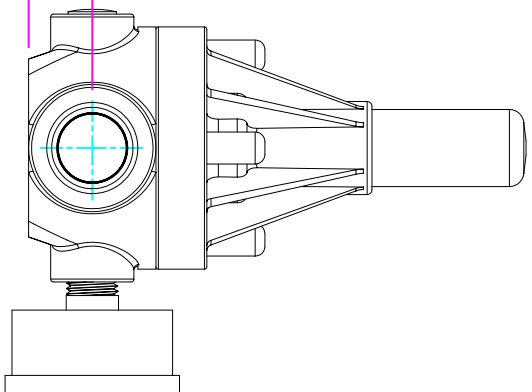

**PRIMARY FLUID SYSTEMS INC.**

1050 Cooke Blvd., Burlington, Ontario L7T 4A8

**ECD VALVE WITH 1/2" BSPT FEMALE & GAUGE**

DWG NAME: 0.5" BSPT EV

DWG TYPE: PLANAR VIEW 2-D

PROJECT: A-SERIES ECD SH: 1 OF 1 DRAWN BY: VICTOR W.L.

DATE ISSUED: 26-JUL-10 SCALE: 1/2 UNITS: INCHES

ECD-50B-PVC-P-GAUGE-2D

MATERIAL: POLY

APPROVED BY:



DIMENSIONAL TOLERANCE: XXX = ± 0.25"

REV: 0  
SHEET SIZE: 8.5 x 11

**A**