

THIS DRAWING IS THE PROPERTY OF PRIMARY FLUID SYSTEMS INC. FROM WHICH A WRITTEN CONSENT FOR APPROVAL SHALL BE REQUIRED PRIOR TO COPYING.

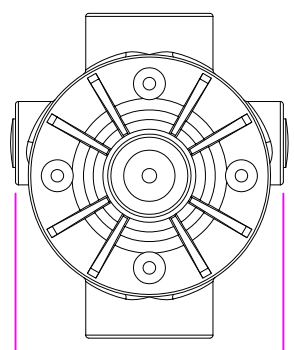

WIDTH
2.80" [71mm]

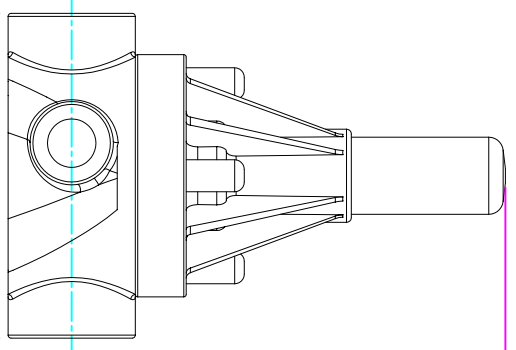

LENGTH (L)
3.40" [86mm]

4.48" [114mm]
HEIGHT (H)

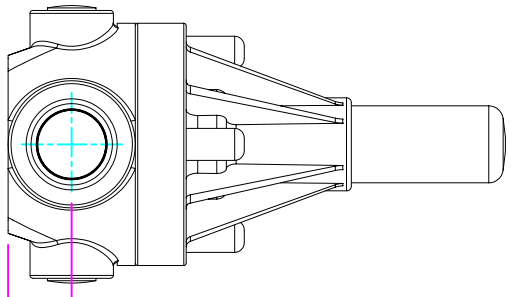
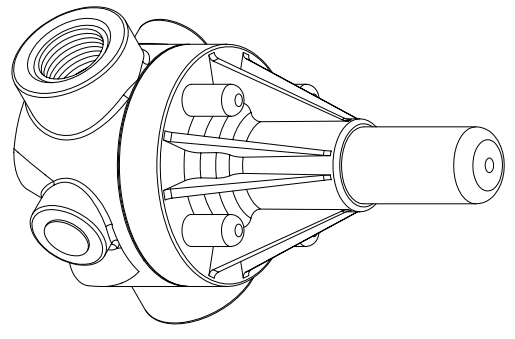

0.66" [17mm]
HEIGHT (h)

PRIMARY FLUID SYSTEMS INC.

1050 Cooke Blvd., Burlington, Ontario L7T 4A8

ECD VALVE
WITH 1/2" BSP FEMALE

DWG NAME: 0.5" BSP FEMALE
DVG TYPE: PLANAR VIEW 2-D

PROJECT: A-SERIES ECD
DATE ISSUED: 26-JUL-10
ECD-50B-PVC-P-2D
MATERIAL: POLY

SHT: 1 OF 1
SCALE: 1:2
UNITS: INCHES

DRAWN BY: VICTOR V.
REVISION: 0

APPROVED BY: [Signature]



DIMENSIONAL TOLERANCE
XXX = ± 0.25"

8.5 X 11
SHEET
SIZE: A