

THIS DRAWING IS THE PROPERTY OF PRIMARY FLUID SYSTEMS INC. FROM WHICH A WRITTEN CONSENT FOR APPROVAL SHALL BE REQUIRED PRIOR TO COPYING.

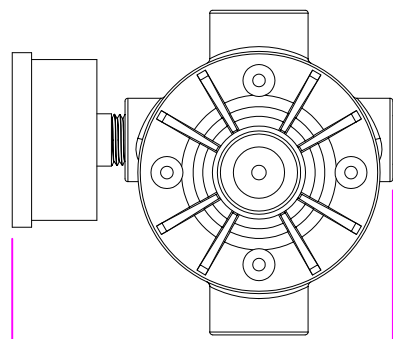

3.93" [100mm]
WIDTH

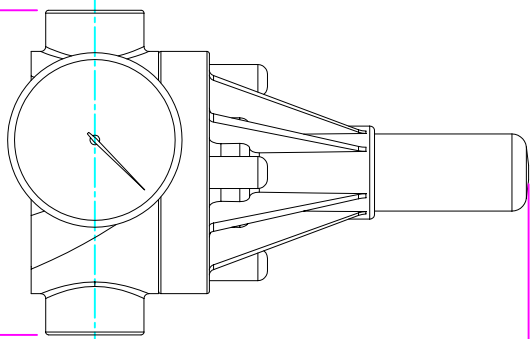

3.40" [86mm]
LENGTH (L)

4.48" [114mm]
HEIGHT (H)

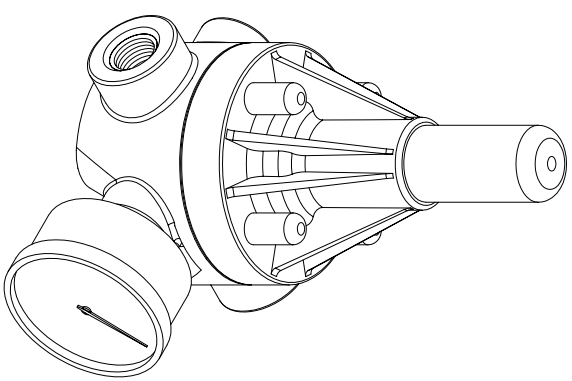

0.66" [17mm]
HEIGHT (h)

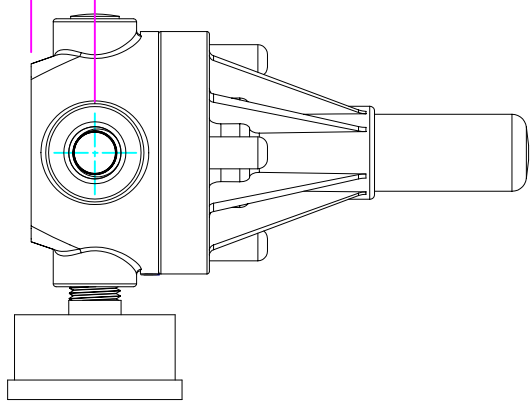

PRIMARY FLUID SYSTEMS INC.

1050 Cooke Blvd, Burlington, Ontario L7T 4A8

ECD VALVE WITH 1/4" BSP FEMALE & GAUGE

0.25" BSP FEMALE

PLANAR VIEW 2-D

PROJECT: A-SERIES ECD
DATE ISSUED: 22-JUL-10
ECD-25B-PVC-P-GAUGE-2D

SHT: 1 OF 1
SCALE: 1:2
MATERIAL: POLY

DRAWN BY: VICTOR V.
UNITS: INCHES

APPROVED BY:

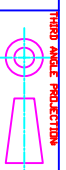

THIRD ANGLE PROJECTION
DIMENSIONAL TOLERANCE
XXX = ± 0.25"
REV.#: 0
SHEET: 05 X 11
SIZE: A