

THIS DRAWING IS THE PROPERTY OF PRIMARY FLUID SYSTEMS INC. FROM WHICH A WRITTEN CONSENT FOR APPROVAL SHALL BE REQUIRED PRIOR TO COPYING.

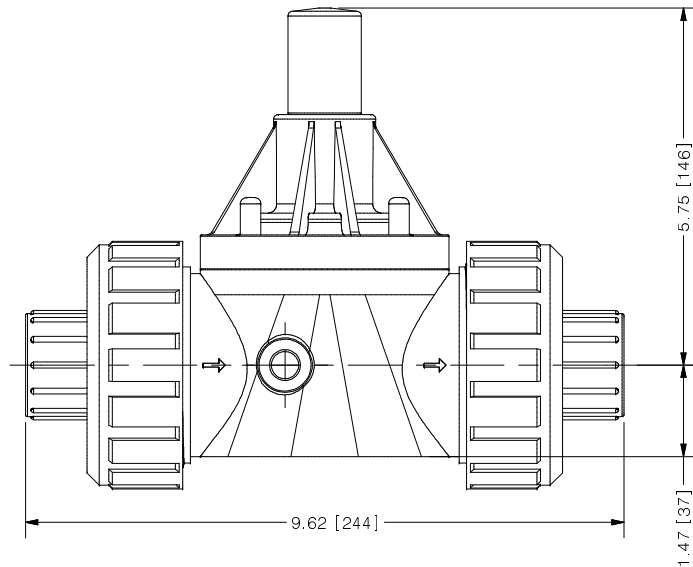

SCALE 1 : 2

ECO VALVE® C-SERIES BACK PRESSURE VALVE

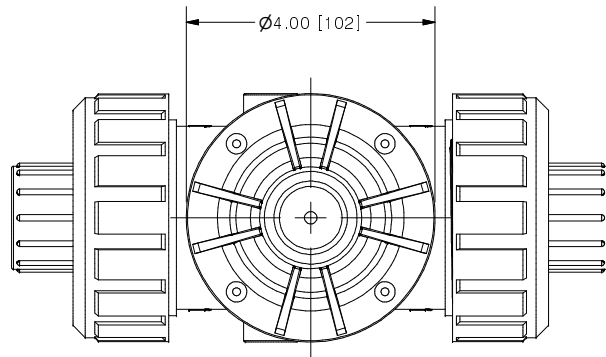
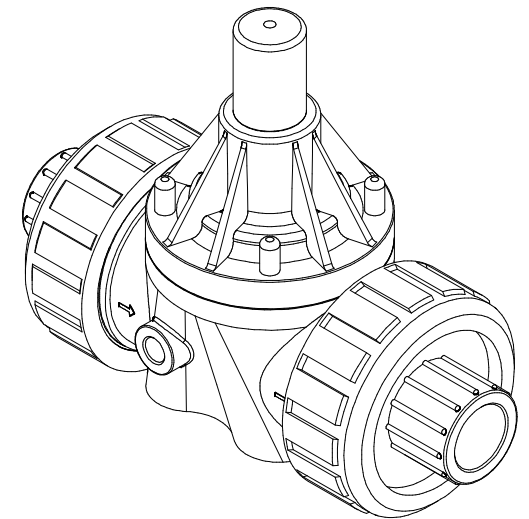
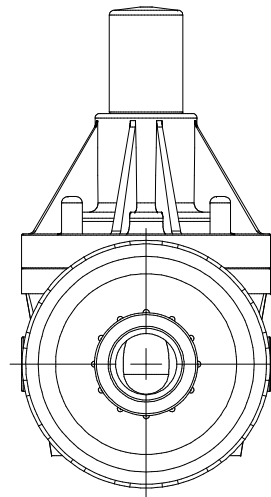

NO.	NAME	DESCRIPTION
1	MAX ALLOWABLE OPERATING TEMPERATURE	180°F (82°C) / 140°F (60°C) FOR PVC BODY
2	MAX ALLOWABLE OPERATING PRESSURE	150 PSIG @ 70°F
3	SIZE: INLET/OUTLET	1"
4	CONNECTION TYPE	NPT UNION INSERT
5	MATERIALS (WETTED)	BODY DIAPHRAGM UNION ORING
6		PVC (CPVC, PP AND PVDF OPTIONAL)
7		PTFE BACKED EPDM (PVC, EPDM AND VITON OPTIONAL)
8		VITON
9	MATERIALS (NON-WETTED)	SPRING BONNET/TOP CPVC
10		SPRING NICKEL PLATED MUSIC WIRE ASTM A228
11		TOP/BOTTOM DISC POLYPROPYLENE
12		BOLTS, NUTS, WASHERS 18-8 SS, ANSI B1 8.3
13		FACTORY SET PRESSURE 50 PSIG
14		SPRING RANGE 7-150 PSIG

0	NEW DRAWING	--	--
REV	DESCRIPTION	DATE	NAME
REVISION HISTORY			

PRIMARY FLUID SYSTEMS INC. 1050 COOKE BLVD. BURLINGTON, ONTARIO L7T 4A8		PROJECT: EV C-SERIES	SHT: 1 OF 1	DRAWN BY: NG
TITLE: BACK PRESSURE ECO VALVE C-SERIES WITH UNION NUT AND 1" NPT INSERTS		DATE DRAWN: 8/4/2016	SCALE: 1 : 2	UNITS: INCH [mm]
MATERIAL: SEE CHART		DWG NO: ECO-110G-PVC_R0	APPROVED BY: CHECKED BY:	
DWG NAME: ECO VALVE		DWG TYPE: PLANAR VIEW		THIRD ANGLE PROJECTION
				0
				B