

THIS DRAWING IS THE PROPERTY OF PRIMARY FLUID SYSTEMS INC. FROM WHICH A WRITTEN CONSENT FOR APPROVAL SHALL BE REQUIRED PRIOR TO COPYING.

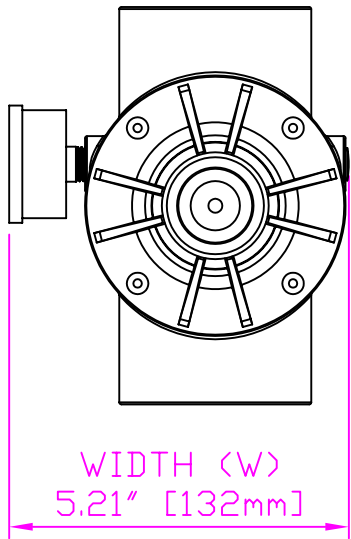

WIDTH (W)
5.21" [132mm]

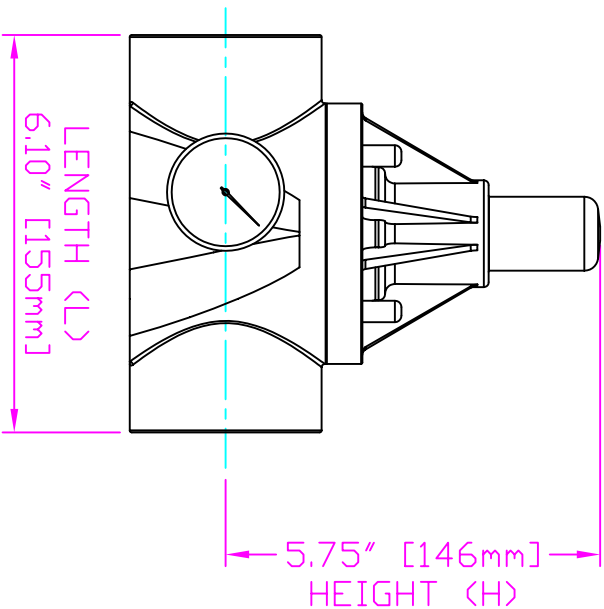

LENGTH (L)
6.10" [155mm]

5.75" [146mm]
HEIGHT (H)

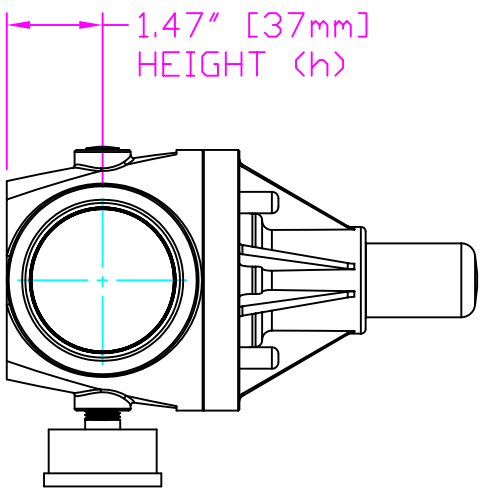
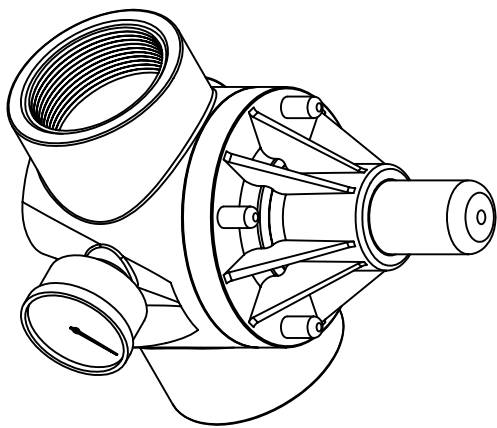

1.47" [37mm]
HEIGHT (h)

THIS DRAWING WITH DIMENSIONS
APPLY TO FOLLOWING MODELS:

- ECD-2004-PVC-P-GAUGE
- ECD-2004-CPVC-T-GAUGE
- ECD-2004-PP-T-GAUGE
- ECD-2004-PVDF-T-GAUGE
- ECD-2003-PVC-P-GAUGE
- ECD-2003-CPVC-T-GAUGE
- ECD-2003-PP-T-GAUGE
- ECD-2003-PVDF-T-GAUGE

PRIMARY FLUID SYSTEMS INC.

1050 Cooke Blvd., Burlington, Ontario L7T 4A8

TITLE
2" THREADED
ECD VALVE
WITH GAUGE

DWG TYPE:

PLANAR VIEW 2D

PROJECT C-SERIES ECD SHIT 1 OF 1 DRAWN BY VICTOR W. L.

DATE ISSUED: 25-NOV-11 SCALE: 1:3 UNITS: INCHES

DWG NO: ECO-200A-PVC-P-GAUGE-2D

MATERIAL: POLY

APPROVED BY:

APPROVED BY:

DIMENSIONAL TOLERANCE
XXX = ± 0.25"



8.5 X 11
SHEET
SIZE:
A