

THIS DRAWING IS THE PROPERTY OF PRIMARY FLUID SYSTEMS INC. FROM WHICH A WRITTEN CONSENT FOR APPROVAL SHALL BE REQUIRED PRIOR TO COPYING.

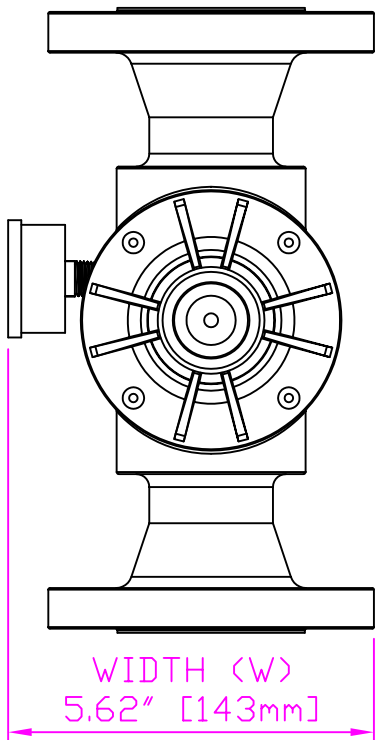

WIDTH (W)
5.62" [143mm]

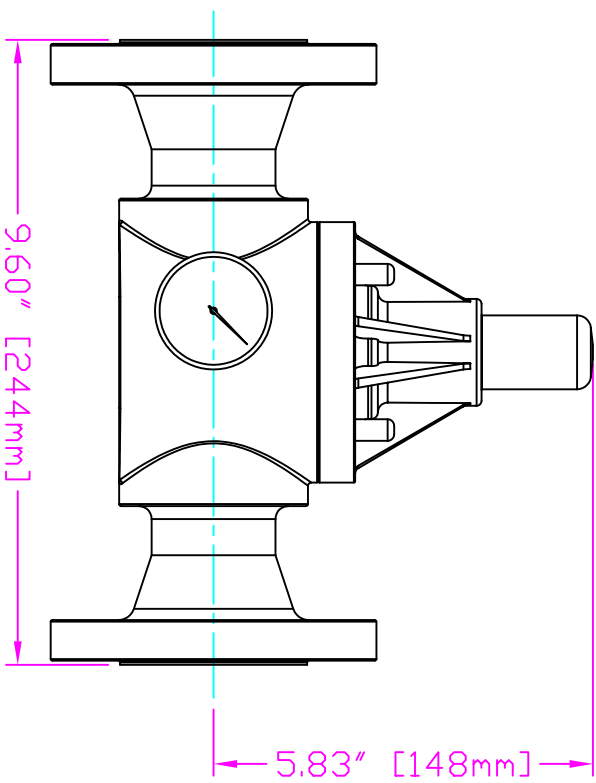

9.60" [244mm]
LENGTH (L)

5.83" [148mm]
HEIGHT (H)

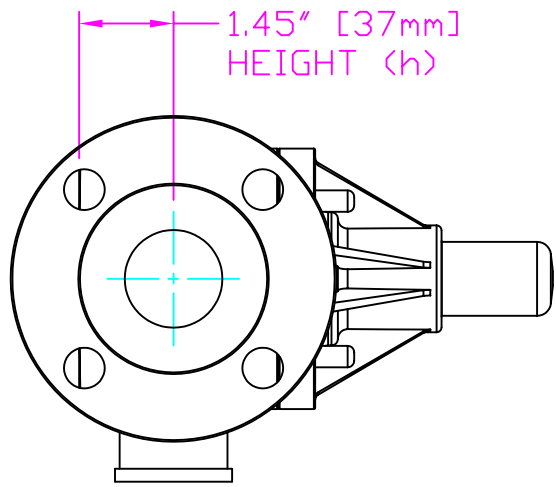
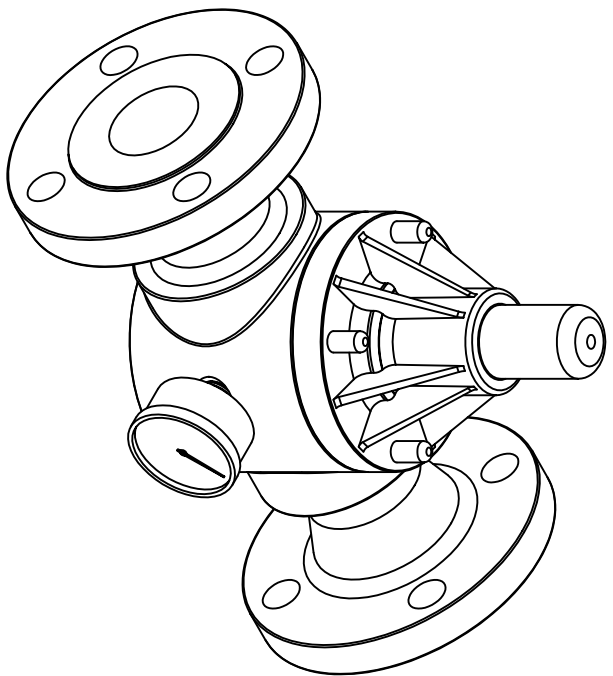

1.45" [37mm]
HEIGHT (h)

THIS DRAWING WITH DIMENSIONS
APPLY TO FOLLOWING MODELS:

- ECD-150E-SS-T-GAUGE
- ECD-150E-AL20-T-GAUGE
- ECD-150E-HAST-T-GAUGE
- ECD-150F-SS-T-GAUGE
- ECD-150F-AL20-T-GAUGE
- ECD-150F-HAST-T-GAUGE

PRIMARY FLUID SYSTEMS INC.

1050 Cooke Blvd, Burlington, Ontario L7T 4A8

1 1/2" (DN 40) FLANGED
ECD VALVE
WITH GAUGE

PROJECT: C-SERIES ECD		SHT. 1 OF 1		DRAWN BY: VICTOR W.	
DATE ISSUED: 13-DEC-11		SCALE: 1:3		UNITS: INCHES	
MATERIAL: METALLIC		ECO-150E-SS-T-GAUGE-2D		REV.#: 0	
APPROVED BY:		DIMENSIONAL TOLERANCE XXX = ± 0.25"		SHEET SIZE: 8.5 X 11	
DRAWING TYPES: PLANAR VIEW 2D		HIDDEN AREA PROJECTION:		A	