

THIS DRAWING IS THE PROPERTY OF PRIMARY FLUID SYSTEMS INC. FROM WHICH A WRITTEN CONSENT FOR APPROVAL SHALL BE REQUIRED PRIOR TO COPYING.

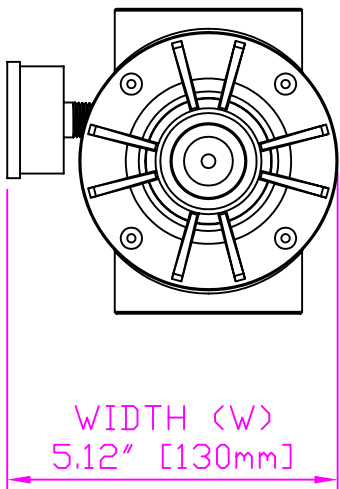

WIDTH (W)  
5.12" [130mm]

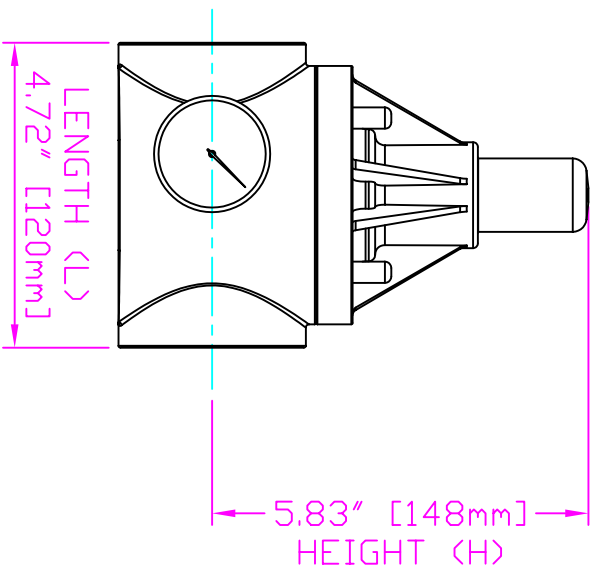
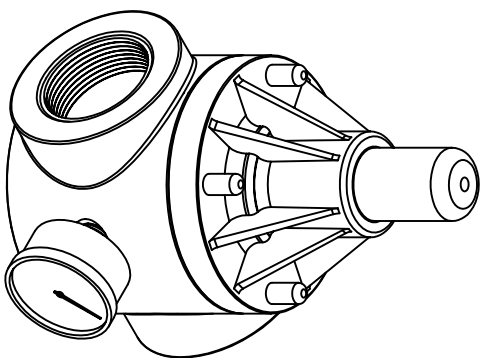

LENGTH (L)  
4.72" [120mm]

5.83" [148mm]  
HEIGHT (H)

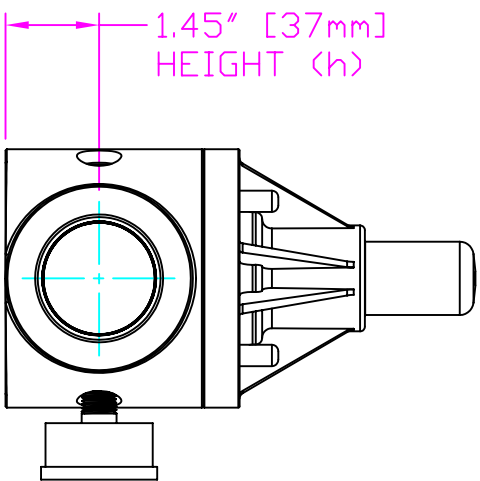

1.45" [37mm]  
HEIGHT (h)

THIS DRAWING WITH DIMENSIONS  
APPLY TO FOLLOWING MODELS:

- ECO-150A-SS-T-GAUGE
- ECO-150A-AL20-T-GAUGE
- ECO-150A-HAST-T-GAUGE
- ECO-150B-SS-T-GAUGE
- ECO-150B-AL20-T-GAUGE
- ECO-150B-HAST-T-GAUGE

**PRIMARY FLUID SYSTEMS INC.**

1050 Cooke Blvd., Burlington, Ontario L7T 4A8

**TITLE**  
1 1/2" THREADED  
ECO VALVE  
WITH GAUGE

**DWG TYPE**

PLANAR VIEW 2D

**PROJECT:** C-SERIES ECO    **SHT:** 1 OF 1    **DRAWN BY:** VICTOR W.  
**DATE ISSUED:** 13-DEC-11    **SCALE:** 1/3    **UNITS:** INCHES  
**DWG NDI:** ECO-150A-SS-T-GAUGE-2D

**MATERIAL:** METALLIC    **REV.#:** 0  
**APPROVED BY:**    **DIMENSIONAL TOLERANCE:** XXX = ± 0.25"  
**THIRD ANGLE PROJECTION**

**A**  
SHEET SIZE: 8.5 x 11