

THIS DRAWING IS THE PROPERTY OF PRIMARY FLUID SYSTEMS INC. FROM WHICH A WRITTEN CONSENT FOR APPROVAL SHALL BE REQUIRED PRIOR TO COPYING.

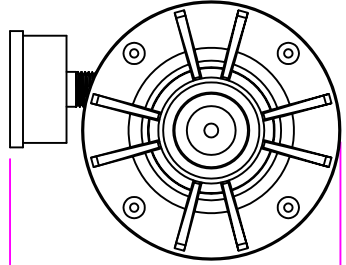

WIDTH (W)
5.12" [130mm]

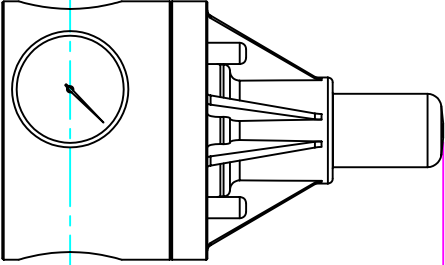

LENGTH (L)
4.00" [102mm]

5.78" [147mm]
HEIGHT (H)

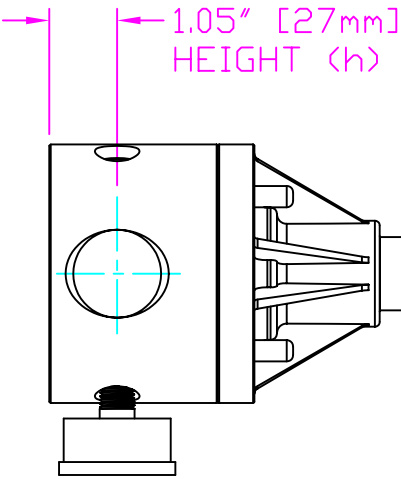
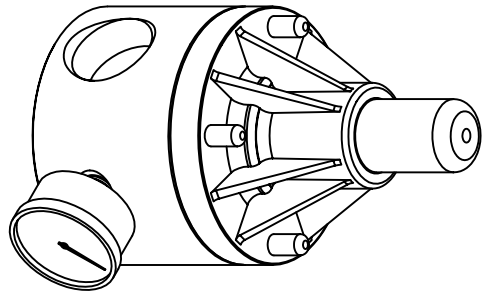

1.05" [27mm]
HEIGHT (h)

THIS DRAWING WITH DIMENSIONS
APPLY TO FOLLOWING MODELS:

- ECD-110C-SS-T-GAUGE
- ECD-110C-ALL20-T-GAUGE
- ECD-110C-HAST-T-GAUGE
- ECD-110D-SS-T-GAUGE
- ECD-110D-ALL20-T-GAUGE
- ECD-110D-HAST-T-GAUGE

PRIMARY FLUID SYSTEMS INC.

1050 Cooke Blvd., Burlington, Ontario L7T 4A8

1" (DN 25) SOCKETED
ECD VALVE (HIGH FLOW VERSION)
WITH GAUGE

DWG TYPE:

PLANAR VIEW, 2D

PROJECT: C-SERIES ECD	SHT: 1 OF 1	DRAWN BY: VICTOR V.L.
DATE ISSUED: 12-DEC-11	SCALE: 1:3	UNITS: INCHES
DWG. NO.: ECO-110C-SS-T-GAUGE-2D		REV.#: 0
MATERIAL: METALLIC		DIMENSIONAL TOLERANCE XXX = ± 0.25"
APPROVED BY:	THIRD ANGLE PROJECTION	SHEET: 11
		SIZE: A