

NOTE: SERIAL NUMBER & MODEL REQUIRED FOR PARTS ORDER

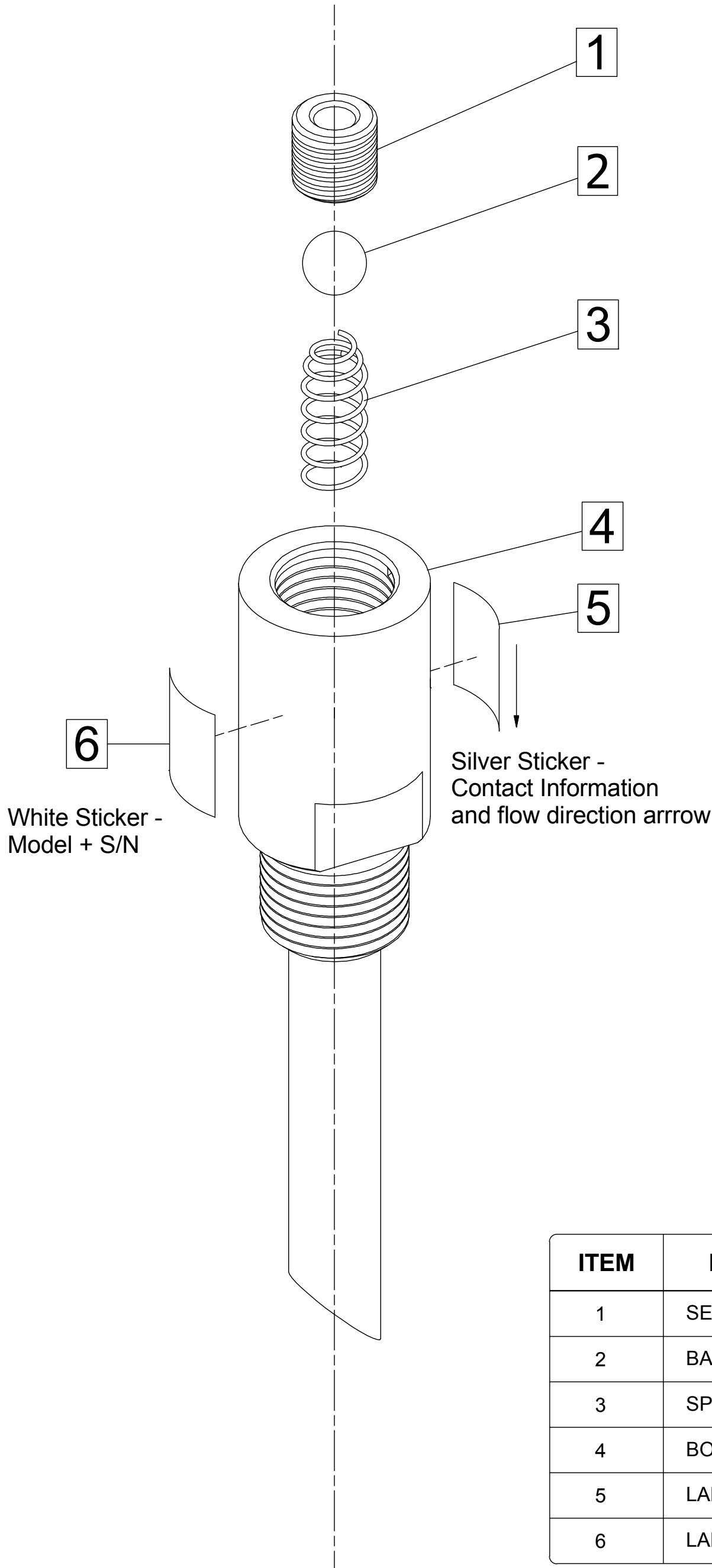

MATERIAL/SIZE CODING

W = S/S6 = (316 STAINLESS STEEL)
 W = HAST = (HASTELLOY C276)
 W = ALL20 = (ALLOY20)
 W = TITA = (TITANIUM GR.2)

X = S/S6 = (316 STAINLESS STEEL)
 X = HAST = (HASTELLOY C276)
 X = TITA = (TITANIUM Gr.2)
 X = CR = (CERAMIC)
 X = GFTFE = (25% GF TEFLON)
 X = PVDF = (PVDF)

Y = S/S6 = (316 STAINLESS STEEL)
 Y = HAST = (HASTELLOY C276)
 Y = TITA = (TITANIUM BETA C)

Z = 3" INSERTION UNITS
 Z = 5" INSERTION UNITS
 Z = OTHER THAN STANDARD LENGTH
 CONTACT FACTORY

^ = S = (316 STAINLESS STEEL)
 ^ = H = (HASTELLOY C276)
 ^ = A = (ALLOY20)
 ^ = T = (TITANIUM GR. 2)

ITEM	DESCRIPTOIN	PART NUMBER
1	SEAT, CHECK	IQF - 1W - SEAT
2	BALL, CHECK	IQF - 1X - BALL
3	SPRING, CHECK	IQF - 1Y - SPRING
4	BODY, QUILL	IQF - 5Z - ^
5	LABEL, DIRECTION, SILVER	IQF - LABEL - DIR
6	LABEL, MODEL + SERIAL #	MSLABEL

DO NOT COPY WITHOUT PRIOR WRITTEN APPROVAL FROM PRIMARY FLUID SYSTEMS. ACCEPTABILITY OF SPECIFICATIONS ARE THE CLIENT'S RESPONSIBILITY.

Primary Fluid Systems Inc.
 1050 Cooke Boulevard, Burlington, Ontario L7T 4A8

PFS INJECTION QUILL - ALLOY
 EXPLODED VIEW

SCALE: 1.5:1 DIMENSIONAL TOLERANCE +/- .25"
 DATE: 01-02-2013 APPROVED BY: CHECKED BY: DWG NO.: REV. #
 DRAWN BY: Neal, Y IQF-EXP-ALLOY 0