

THIS DRAWING IS THE PROPERTY OF PRIMARY FLUID SYSTEMS INC. FROM WHICH A WRITTEN CONSENT FOR APPROVAL SHALL BE REQUIRED PRIOR TO COPYING.

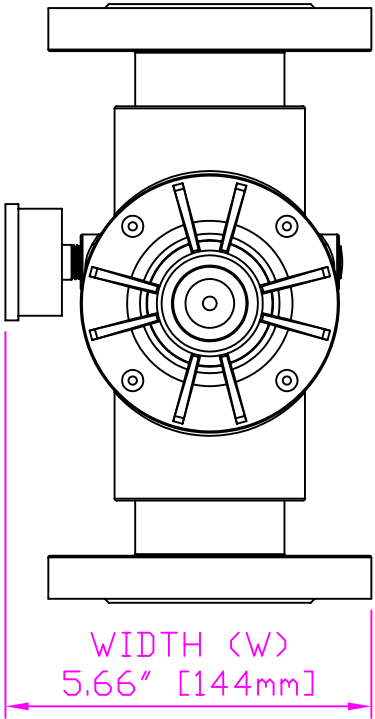

WIDTH (W)  
5.66" [144mm]

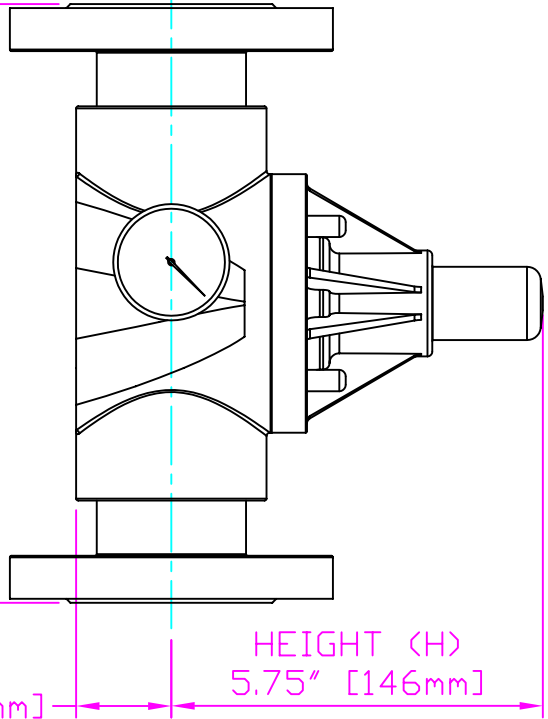

9.27" [235mm]  
LENGTH (L)

HEIGHT (H)  
5.75" [146mm]

1.47" [37mm]  
HEIGHT (h)

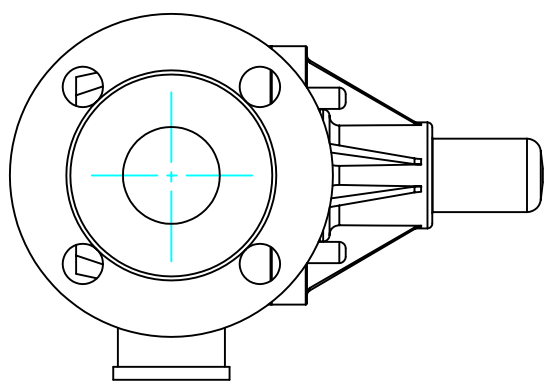
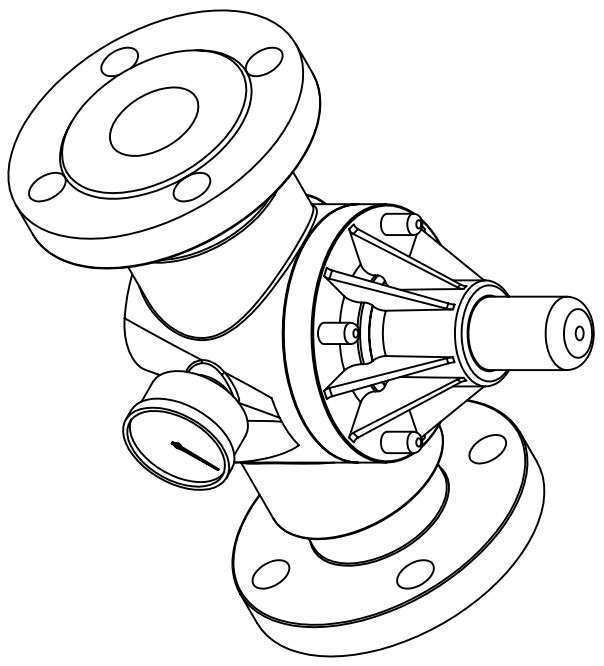

- THIS DRAWING WITH DIMENSIONS  
APPLY TO FOLLOWING MODELS:
- ECCO-150E-PVC-P-GAUGE
  - ECCO-150E-CPVC-T-GAUGE
  - ECCO-150E-PP-T-GAUGE
  - ECCO-150E-PVDF-T-GAUGE
  - ECCO-150F-PVC-P-GAUGE
  - ECCO-150F-CPVC-T-GAUGE
  - ECCO-150F-PP-T-GAUGE
  - ECCO-150F-PVDF-T-GAUGE

**PRIMARY FLUID SYSTEMS INC.**

1050 Cooke Blvd, Burlington, Ontario L7T 4A8

1 1/2" DN 40) FLANGED  
ECCO VALVE  
WITH GAUGE

PROJECT: C-SERIES ECCO		SHT: 1 OF 1		DRAWN BY: VICTOR V.	
DATE ISSUED: 6-DEC-11		SCALE: 1:3		UNITS: INCHES	
DVG NDI:		ECCO-150E-PVC-P-GAUGE-2D		REV: # 1	
MATERIAL: POLY		DIMENSIONAL TOLERANCE XXX = ± 0.25"		SHEET SIZE: 8.5 X 11	
APPROVED BY:		TRIMD ANGLE PROJECTION		A	
DVG TYPE: PLANAR VIEW 2D					