

THIS DRAWING IS THE PROPERTY OF PRIMARY FLUID SYSTEMS INC. FROM WHICH A WRITTEN CONSENT FOR APPROVAL SHALL BE REQUIRED PRIOR TO COPYING.

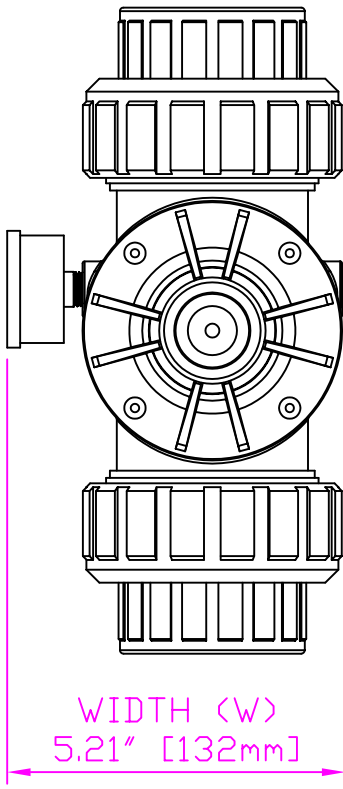

WIDTH (W)
5.21" [132mm]

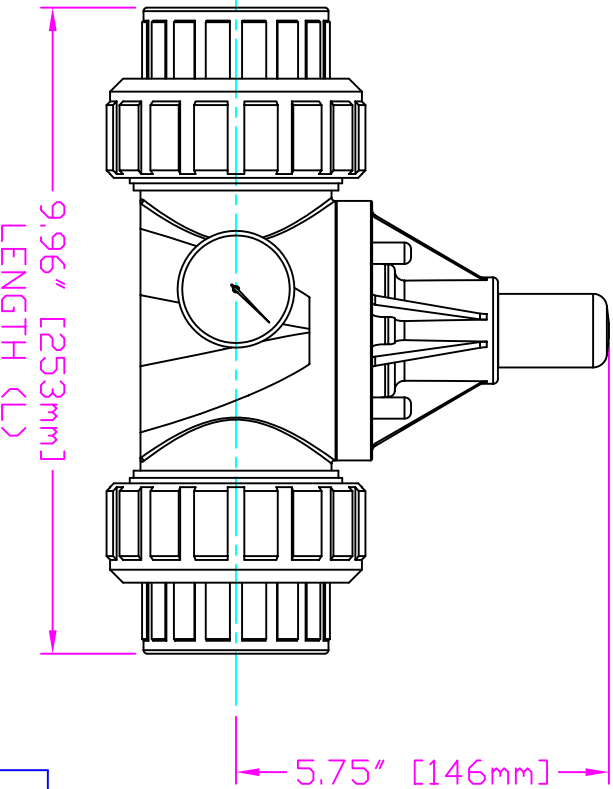

9.96" [253mm]
LENGTH (L)

5.75" [146mm]
HEIGHT (H)

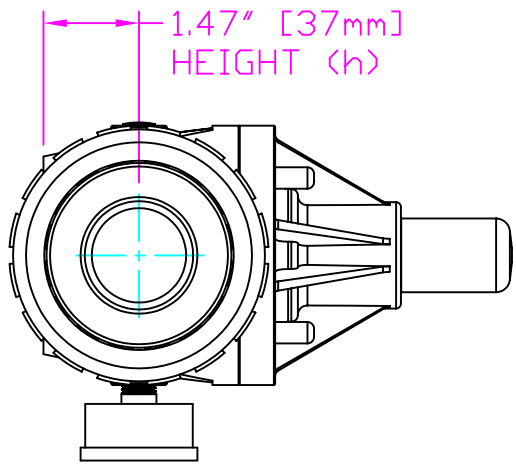
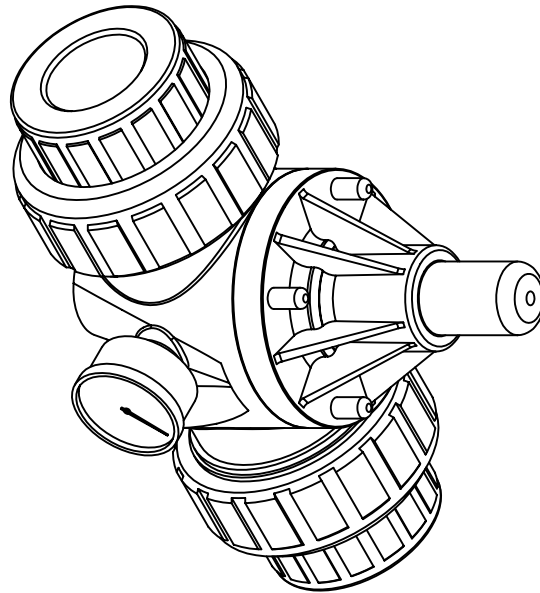

1.47" [37mm]
HEIGHT (h)

- THIS DRAWING WITH DIMENSIONS
APPLY TO FOLLOWING MODELS:
- ECD-125I-PVC-P-GAUGE
 - ECD-125I-CPVC-T-GAUGE
 - ECD-125I-PP-T-GAUGE
 - ECD-125I-PVDF-T-GAUGE
 - ECD-125J-PVC-P-GAUGE
 - ECD-125J-CPVC-T-GAUGE
 - ECD-125J-PP-T-GAUGE
 - ECD-125J-PVDF-T-GAUGE

PRIMARY FLUID SYSTEMS INC.

UNION X 1/4" (DN 32) SOCKETED
ECD VALVE
WITH GAUGE

1050 Cooke Blvd, Burlington, Ontario L7T 4A8

PROJECT: C-SERIES ECD		SHT. 1 OF 1		DRAWN BY: VICTOR V.L.	
DATE ISSUED: 23-NOV-11		SCALE: 1:3		UNITS: INCHES	
ECO-125I-PVC-P-GAUGE-2D		MATERIAL: POLY		REVISION: 0	
APPROVED BY:		THIRD ANGLE PROJECTION		DIMENSIONAL TOLERANCE XXX = ± 0.25"	
DVG TYPE: PLANAR VIEW 2D		SHEET SIZE: 8.5 X 11		A	