

THIS DRAWING IS THE PROPERTY OF PRIMARY FLUID SYSTEMS INC. FROM WHICH A WRITTEN CONSENT FOR APPROVAL SHALL BE REQUIRED PRIOR TO COPYING.

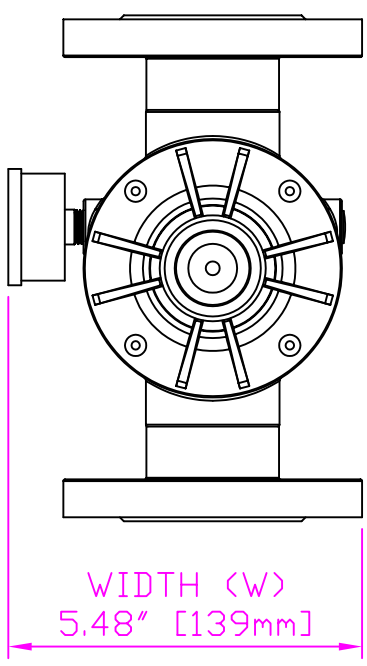

WIDTH (W)  
5.48" [139mm]

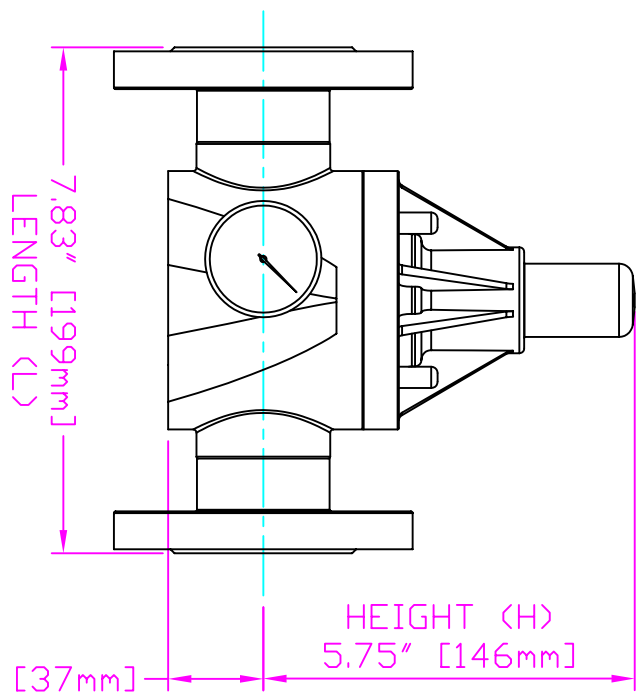

HEIGHT (H)  
5.75" [146mm]

1.47" [37mm]  
HEIGHT (h)

LENGTH (L)  
7.83" [199mm]

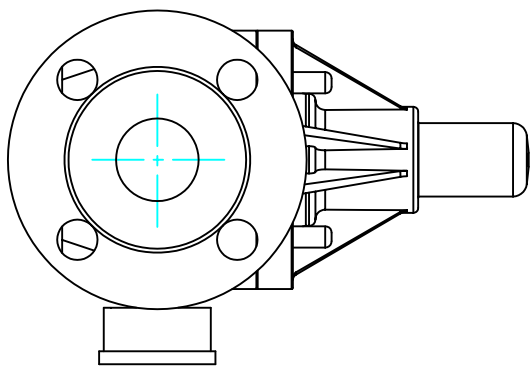
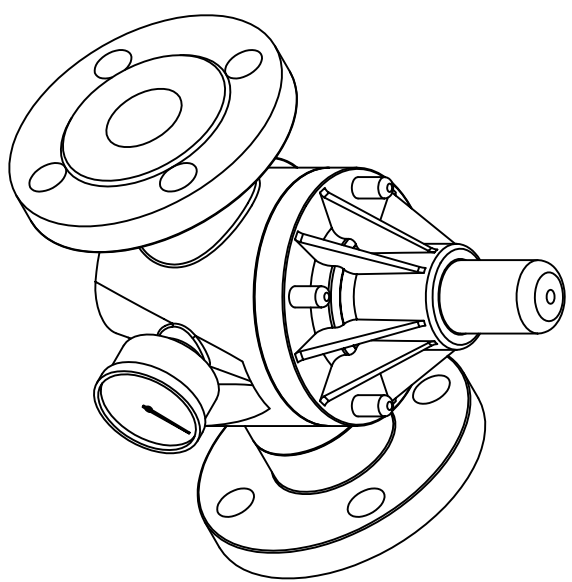

THIS DRAWING WITH DIMENSIONS  
APPLY TO FOLLOWING MODELS:

- ECD-125E-PVC-P-GAUGE
- ECD-125E-GPVC-T-GAUGE
- ECD-125E-PP-T-GAUGE
- ECD-125E-PVDF-T-GAUGE
- ECD-125F-PVC-P-GAUGE
- ECD-125F-GPVC-T-GAUGE
- ECD-125F-PP-T-GAUGE
- ECD-125F-PVDF-T-GAUGE

**PRIMARY FLUID SYSTEMS INC.**

1050 Cooke Blvd., Burlington, Ontario L7T 4A8

TITLE:  
1½" (DN 32) FLANGED  
ECD VALVE  
WITH GAUGE

DWG TYPE: PLANAR VIEW 2D

PROJECT: C-SERIES ECD  
DATE ISSUED: 6-DEC-11  
SHT. 1 OF 1  
SCALE: 1:3  
DRAWN BY: VICTOR W.L.

DWG NO.:  
ECO-125E-PVC-P-GAUGE-2D  
MATERIAL: POLY  
DIMENSIONAL TOLERANCE  
XXX = ± 0.25"

APPROVED BY: [Signature]



REV.#: 1  
SHEET: 85 X 11  
SIZE: A