

THIS DRAWING IS THE PROPERTY OF PRIMARY FLUID SYSTEMS INC. FROM WHICH A WRITTEN CONSENT FOR APPROVAL SHALL BE REQUIRED PRIOR TO COPYING.

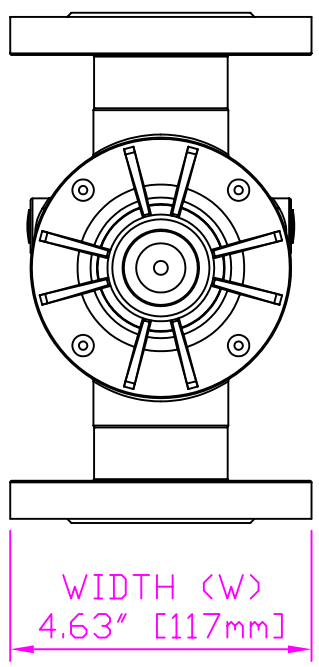

WIDTH (W)  
4.63" [117mm]

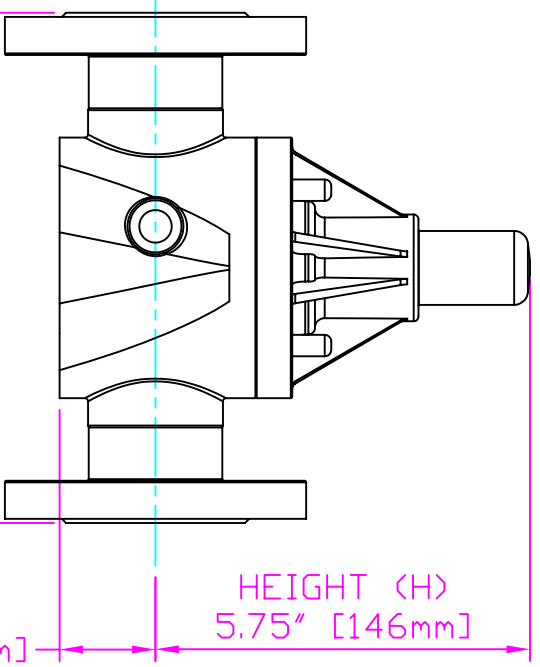
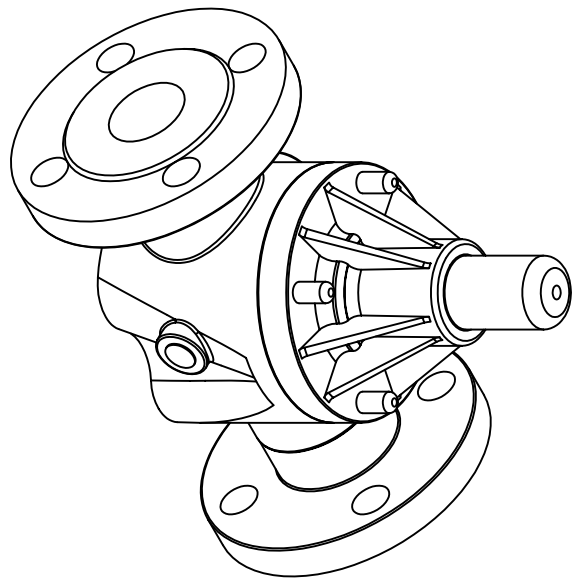

7.83" [199mm]  
LENGTH (L)

HEIGHT (H)  
5.75" [146mm]

1.47" [37mm]  
HEIGHT (h)

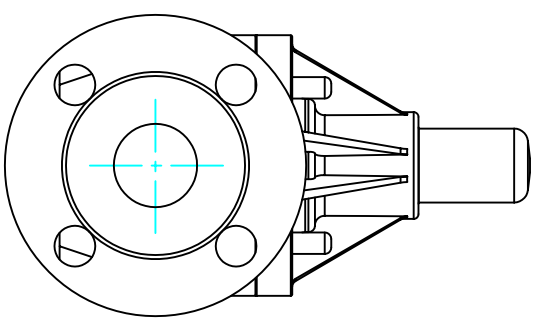

- ECD-125E-PVC-P
- ECD-125E-GPVC-T
- ECD-125E-PP-T
- ECD-125E-PVDF-T
- ECD-125F-PVC-P
- ECD-125F-GPVC-T
- ECD-125F-PP-T
- ECD-125F-PVDF-T

THIS DRAWING WITH DIMENSIONS  
APPLY TO FOLLOWING MODELS:

## PRIMARY FLUID SYSTEMS INC.

1050 Cooke Blvd, Burlington, Ontario L7T 4A8

1 1/4" DN 32" FLANGED  
ECD VALVE

TITLE:		PROJECT: C-SERIES ECD		SHT. 1 OF 1		DRAWN BY: VICTOR W.	
DATE ISSUED: 6-DEC-11		SCALE: 1:3		UNITS: INCHES		REV. #:	
MATERIAL: POLY		ECCO-125E-PVC-P-2D		APPROVED BY:		DIMENSIONAL TOLERANCE XXX = ± 0.25"	
DVG TYPE: PLANAR VIEW 2D		HARD ANGLE PROJECTION		SHEET SIZE: 8.5 X 11		A	