

THIS DRAWING IS THE PROPERTY OF PRIMARY FLUID SYSTEMS INC. FROM WHICH A WRITTEN CONSENT FOR APPROVAL SHALL BE REQUIRED PRIOR TO COPYING.

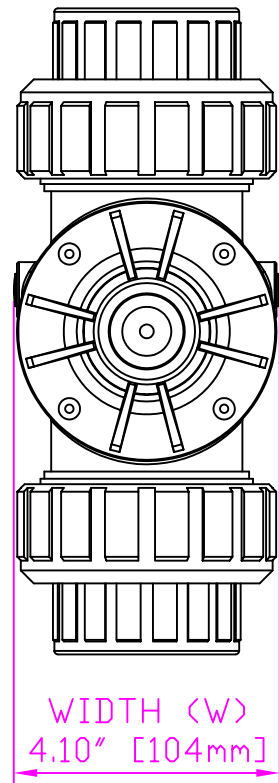

WIDTH (W)
4.10" [104mm]

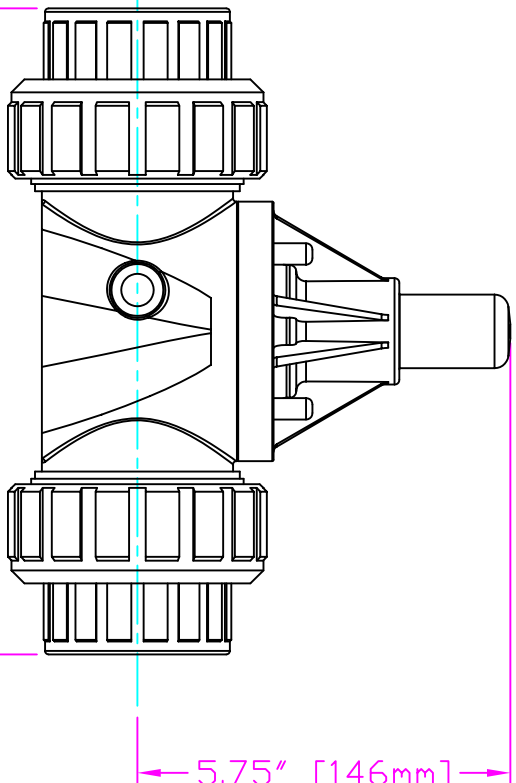

9.96" [253mm]
LENGTH (L)

5.75" [146mm]
HEIGHT (H)

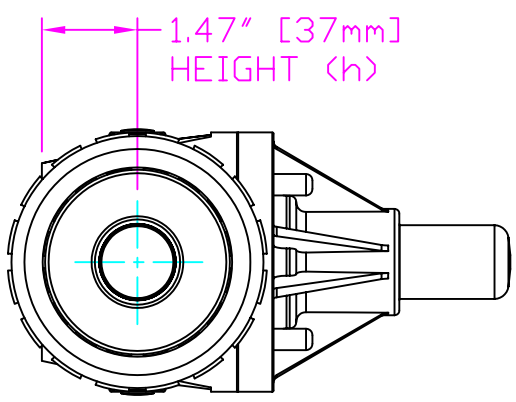
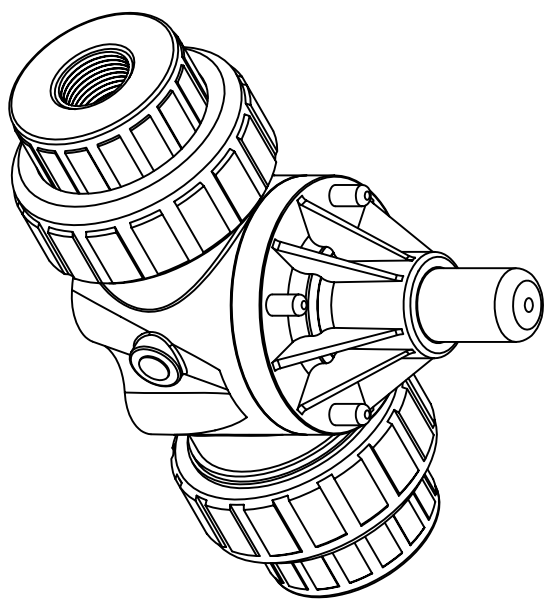

1.47" [37mm]
HEIGHT (h)

- ECD-110G-PVC-P
- ECD-110G-GPVC-T
- ECD-110G-PP-T
- ECD-110G-PVDF-T
- ECD-110H-PVC-P
- ECD-110H-GPVC-T
- ECD-110H-PP-T
- ECD-110H-PVDF-T

THIS DRAWING WITH DIMENSIONS
APPLY TO FOLLOWING MODELS:

PRIMARY FLUID SYSTEMS INC.		PROJECT: C-SERIES ECD		SHT: 1 OF 1		DRAWN BY: VICTOR W.	
1050 Cooke Blvd., Burlington, Ontario L7T 4A8		DATE ISSUED: 24-NOV-11		SCALE: 1:3		UNITS: INCHES	
TITLE: UNION X 1" THREADED ECD VALVE (HIGH FLOW VERSION)		DWG NO: ECO-110G-PVC-P-2D		MATERIAL: POLY		DIMENSIONAL TOLERANCE XXX = ± 0.25"	
DWG TYPE: PLANAR VIEW 2D		APPROVED BY:		HARD ANGLE PROJECTION		REV#: 0	
				8.5 X 11 SHEET SIZE:		A	