

THIS DRAWING IS THE PROPERTY OF PRIMARY FLUID SYSTEMS INC. FROM WHICH A WRITTEN CONSENT FOR APPROVAL SHALL BE REQUIRED PRIOR TO COPYING.

|             | NO. | NAME                                | DESCRIPTION           |
|-------------|-----|-------------------------------------|-----------------------|
|             | 1   | MAX ALLOWABLE OPERATING TEMPERATURE | 500°F (260°C)         |
|             | 2   | MAX ALLOWABLE OPERATING PRESSURE    | 3000 PSIG             |
| CONNECTIONS | 3   | INLET PORT CONNECTION               | 3/4"                  |
|             | 4   | OUTLET PORT CONNECTION              | 3/4"                  |
|             | 5   | TYPE                                | NPT                   |
|             | 7   | ORIFICE SIZE                        | 1/4"                  |
| MATERIALS   | 8   | BODY, QUILL AND CHECK SEAT          | 316SS (HAST OPTIONAL) |
|             | 9   | BALL CHECK                          | 316SS (HAST OPTIONAL) |
|             | 10  | CHECK SPRING                        | 316SS (HAST OPTIONAL) |

## INJECTION QUILLS®

MALE x MALE CONNECTION

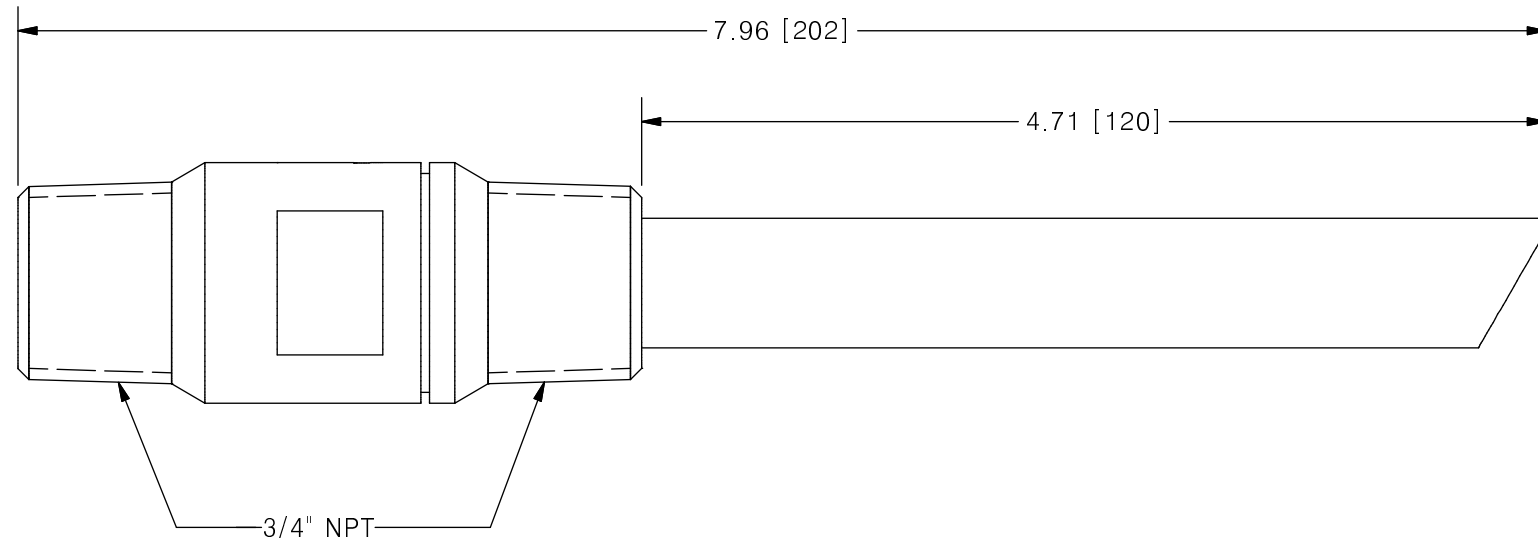
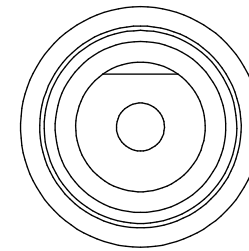
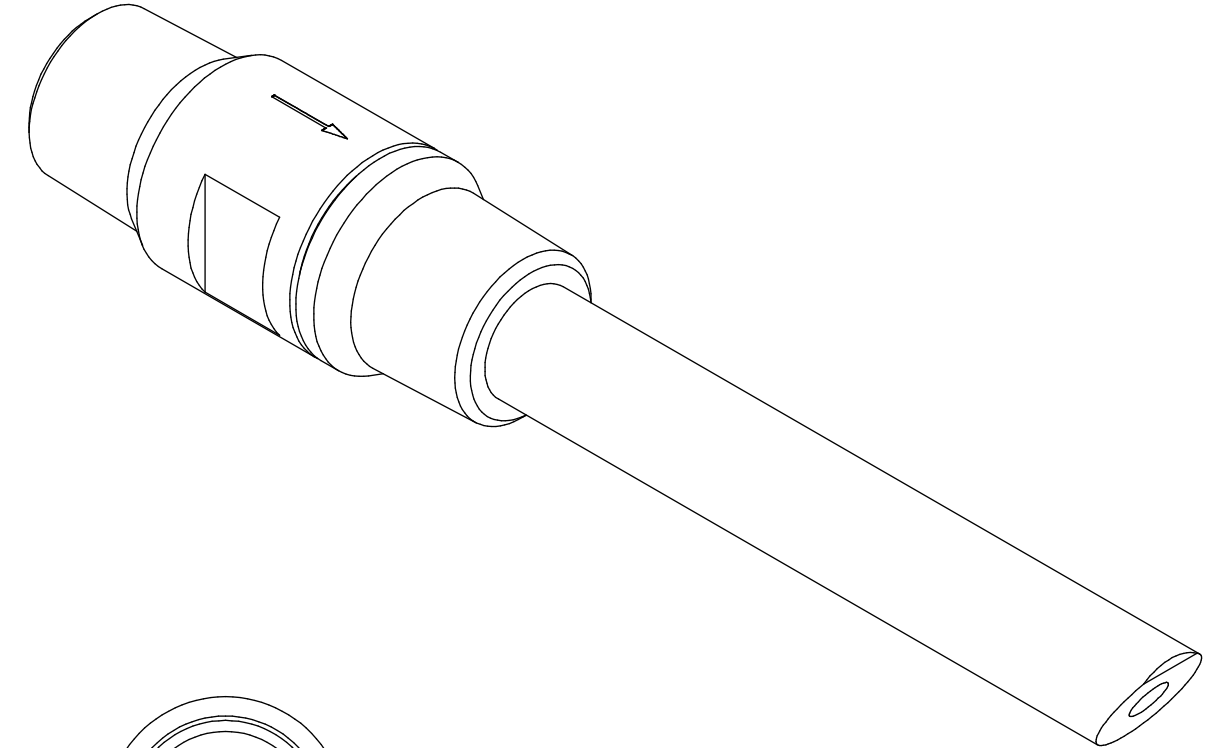
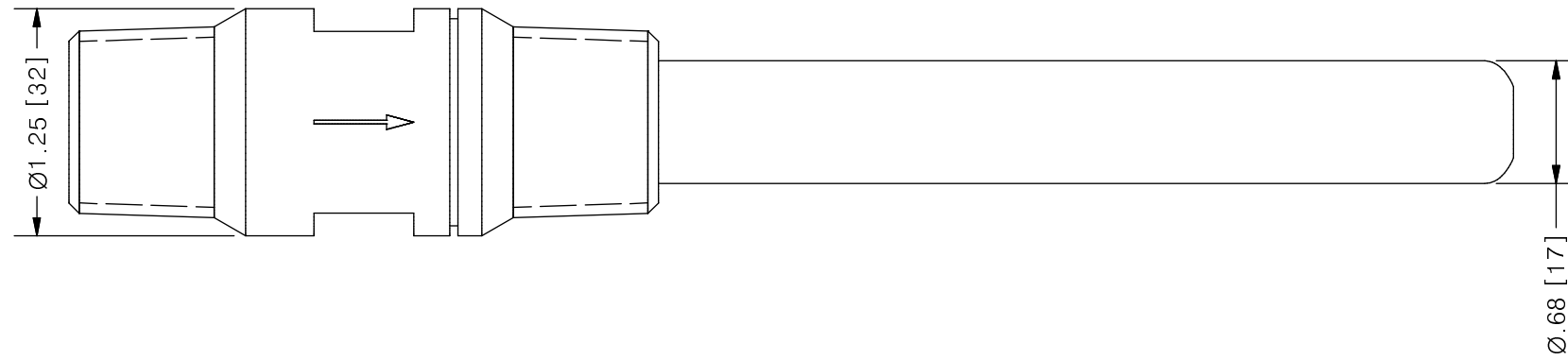

|   |  |   |              |  |
|---|--|---|--------------|--|
| <b>PRIMARY FLUID SYSTEMS INC.</b><br>1050 COOKE BLVD, BURLINGTON, ONTARIO L7T 4A8 |  | PROJECT: IQ                               | SHT: 1 OF 1  | DRAWN BY: TJ   |
| TITLE: 3/4" INJECTION QUILL WITH 1/4" ORIFICE                                     |  | DATE DRAWN: 2/7/2017                      | SCALE: 1 : 1 | UNITS: INCH [mm]   |
| DWG NO: IQ-78-316SS-25  |  | MATERIAL: SEE CHART                       | REV# 0       |  |
| DWG NAME: INJECTION QUILL   |  | APPROVED BY:                              | CHECKED BY:  | <small>DIMENSIONAL TOLERANCE</small><br>0.X = ± 0.25"<br>0.XX = ± 0.25"<br>0.XXX = ± 0.25" |
| DWG TYPE: PLANAR VIEW   |  | <small>THIRD ANGLE PROJECTION</small><br> |              |  |

| REV | DESCRIPTION | DATE | NAME |
|-----|-------------|------|------|
| 0   | NEW DRAWING | --   | --   |

REVISION HISTORY