

THIS DRAWING IS THE PROPERTY OF PRIMARY FLUID SYSTEMS INC. FROM WHICH A WRITTEN CONSENT FOR APPROVAL SHALL BE REQUIRED PRIOR TO COPYING.

NO.	NAME	DESCRIPTION
1	MAX ALLOWABLE OPERATING TEMPERATURE	180°F (82°C) / 140°F (60°C) FOR PVC BODY
2	MAX ALLOWABLE OPERATING PRESSURE	150 PSIG @ 70°F
CONNECTIONS		3 SIZE: INLET/OUTLET 3/4"
4	CONNECTION TYPE	NPT UNION INSERT
MATERIALS (WETTED)		6 BODY 7 DIAPHRAGM 8 UNION ORING 9 SPRING BONNET/TOP
MATERIALS (NON-WETTED)		10 SPRING 11 TOP/BOTTOM DISC 12 BOLTS, NUTS, WASHERS 13 FACTORY SET PRESSURE 14 SPRING RANGE
		PVC (CPVC, PP AND PVDF OPTIONAL) PTFE BACKED EPDM (PVC, EPDM AND VITON OPTIONAL) VITON CPVC NICKEL PLATED MUSIC WIRE ASTM A228 POLYPROPYLENE 18.8 SS, ANSI B18.3 50 PSIG 7-150 PSIG

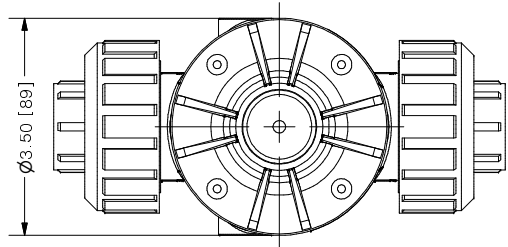

### ECO VALVE® B-SERIES BACK PRESSURE VALVE

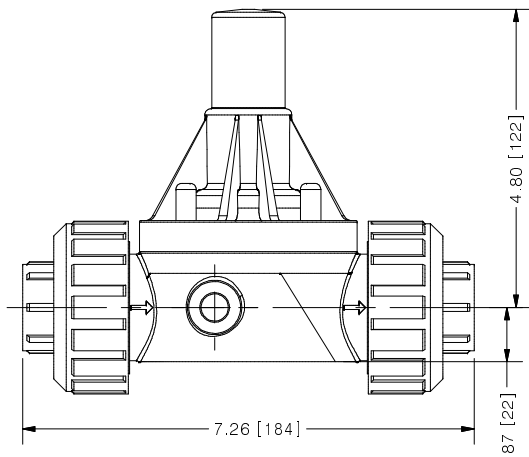
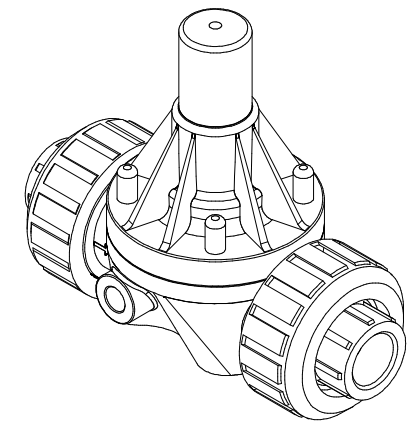

SCALE 1 : 2

REV	DESCRIPTION	DATE	NAME
0	NEW DRAWING	--	--
REVISION HISTORY			

<b>PRIMARY FLUID SYSTEMS INC.</b> 1050 COOKE BLVD. BURLINGTON, ONTARIO L7T 4A8	PROJECT: EV B-SERIES	SHT: 1 OF 1	DRAWN BY: NG
	DATE DRAWN: 8/4/2016	SCALE: 1 : 2	UNITS: INCH [mm]
TITLE: BACK PRESSURE ECO VALVE B-SERIES WITH UNION NUT AND 3/4" NPT INSERT	MATERIAL: SEE CHART	DIMENSIONAL TOLERANCE 0.1X ± 0.25 0.3X ± 0.25 0.5XX ± 0.25	
DWG NO: ECO-75G-PVC_R0	APPROVED BY:	CHECKED BY:	
DWG NAME: ECO VALVE	SHEET SIZE: <b>B</b>		
DWG TYPE: PLANAR VIEW			