

THIS DRAWING IS THE PROPERTY OF PRIMARY FLUID SYSTEMS INC. FROM WHICH A WRITTEN CONSENT FOR APPROVAL SHALL BE REQUIRED PRIOR TO COPYING.

	NO.	NAME	DESCRIPTION
	1	MAX ALLOWABLE OPERATING TEMPERATURE	140°F (60°C)
	2	MAX ALLOWABLE OPERATING PRESSURE	15 PSIG
CONNECTIONS	3	BOTTOM PORT CONNECTION	2"
	4	TOP PORT CONNECTION	DUST CAP
	5	TYPE	FLANGE
MATERIALS	6	CYLINDER	CLEAR PVC
	7	END CAP	PVC
	8	FLANGE, ANSI B16.5	PVC
	9	GLUE	CPVC, CHEMICAL RESISTANT
INPUT DATA	10	VOLUME SIZE	20000 ML / 320 GPH
SCALE	11	BI DIRECTIONAL GRADUATIONS	200 ML / 2 GPH DIVISIONS
	12	ALL CYLINDERS ARE RATED FOR LIQUID SERVICE ONLY	√
COMMENTS	13	CYLINDERS ARE NOT PRESSURE VESSELS	√
		NSF 61 APPROVED	

**CLEARVIEW®**  
CV#3 PVC CALIBRATION CYLINDER

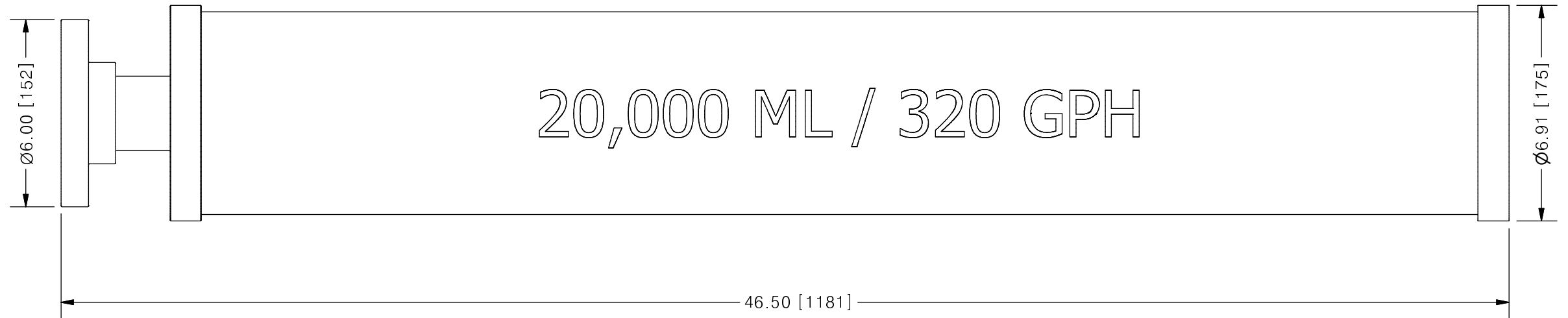
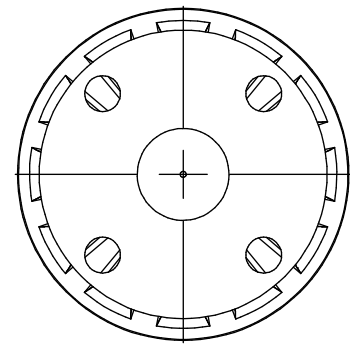

SCALE 1 : 4

REV	DESCRIPTION	DATE	NAME
0	NEW DRAWING	--	--

<b>PRIMARY FLUID SYSTEMS INC.</b> 1050 COOKE BLVD, BURLINGTON, ONTARIO L7T 4A8	PROJECT: CV	SHT: 1 OF 1	DRAWN BY: BRJB
	DATE DRAWN: 6/21/2017	SCALE: 1 : 4	UNITS: INCH [mm]
TITLE: 20000 ML CALIBRATION CYLINDER WITH 2" FLANGE CONNECTION	MATERIAL: SEE CHART	REV# 0	
DWG NO: CV#3-20000-F_R0	DWG NAME: CV CYLINDER	APPROVED BY:	CHECKED BY:
DWG TYPE: PLANAR VIEW	THIRD ANGLE PROJECTION		

DIMENSIONAL TOLERANCE  
 0.X = ± 0.25"  
 0.XX = ± 0.25"  
 0.XXX = ± 0.25"  
 SHEET SIZE: B