

THIS DRAWING IS THE PROPERTY OF PRIMARY FLUID SYSTEMS INC. FROM WHICH A WRITTEN CONSENT FOR APPROVAL SHALL BE REQUIRED PRIOR TO COPYING.

| | NO. | NAME | DESCRIPTION |
|-------------|-----|---|----------------------------|
| | 1 | MAX ALLOWABLE OPERATING TEMPERATURE | 140°F (60°C) |
| | 2 | MAX ALLOWABLE OPERATING PRESSURE | 15 PSIG |
| CONNECTIONS | 3 | BOTTOM PORT CONNECTION | 1/2" |
| | 4 | TOP PORT CONNECTION | DUST CAP |
| | 5 | TYPE | FLANGE |
| MATERIALS | 6 | CYLINDER | CLEAR PVC |
| | 7 | END CAP | PVC |
| | 8 | FLANGE, ANSI B16.5 | PVC |
| | 9 | GLUE | CPVC, CHEMICAL RESISTANT |
| INPUT DATA | 10 | VOLUME SIZE | 1000 ML / 16 GPH |
| SCALE | 11 | BI DIRECTIONAL GRADUATIONS | 10 ML / .125 GPH DIVISIONS |
| | 12 | ALL CYLINDERS ARE RATED FOR LIQUID SERVICE ONLY | √ |
| COMMENTS | 13 | CYLINDERS ARE NOT PRESSURE VESSELS | √ |
| | | NSF 61 APPROVED | |

CLEARVIEW®
CV#3 PVC CALIBRATION CYLINDER

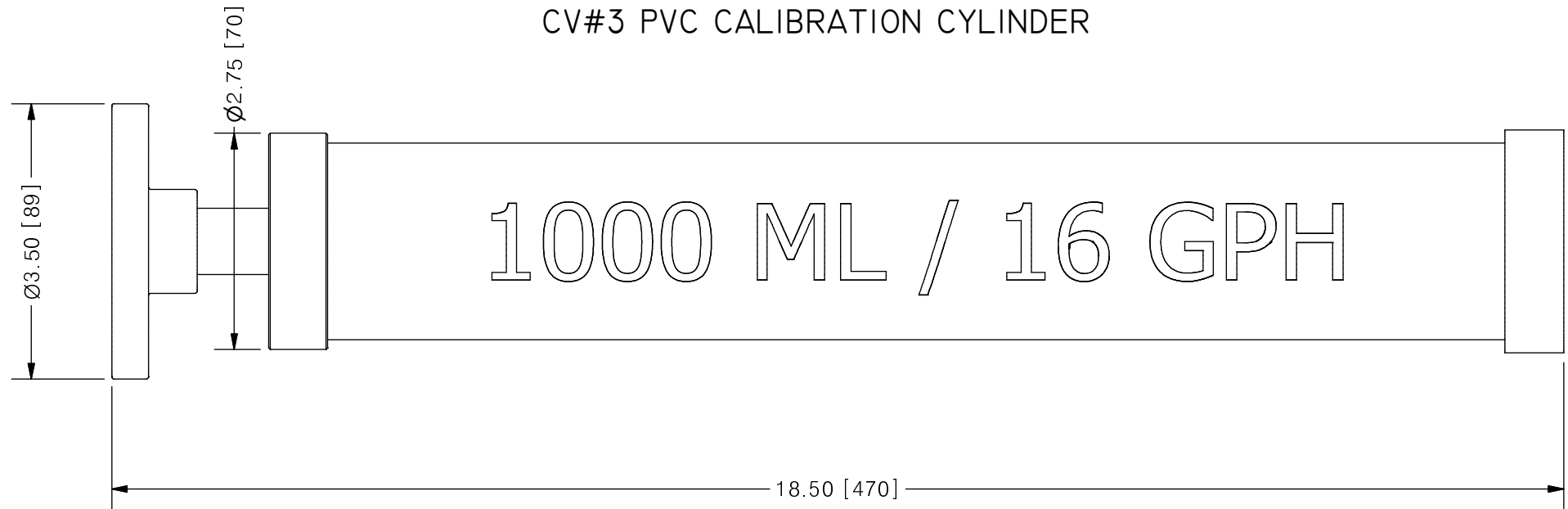
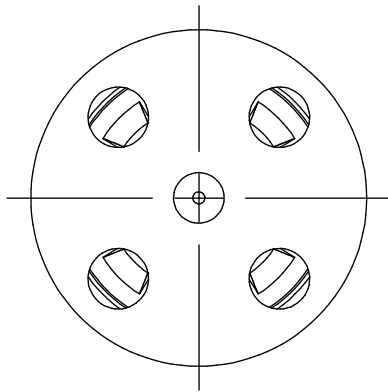

SCALE 1 : 2

| REV | DESCRIPTION | DATE | NAME |
|-----|-------------|------|------|
| 0 | NEW DRAWING | -- | -- |

REVISION HISTORY

| | | | | |
|---|--|---|------------------------|-------------------------|
| PRIMARY FLUID SYSTEMS INC. 1050 COOKE BLVD, BURLINGTON, ONTARIO L7T 4A8 | | PROJECT: CV | SHT: 1 OF 1 | DRAWN BY: BRJB |
| TITLE: 1000 ML CALIBRATION CYLINDER WITH 1/2" FLANGE CONNECTION | | DATE DRAWN: 6/21/2017 | SCALE: 1 : 2 | UNITS: INCH [mm] |
| DWG NAME: CV CYLINDER DWG TYPE: PLANAR VIEW | | MATERIAL: SEE CHART | DWG NO: CV#3-1000-F_R0 | REV# 0 |
| APPROVED BY: _____ CHECKED BY: _____ | | DIMENSIONAL TOLERANCE 0.X = ± 0.25" 0.XX = ± 0.25" 0.XXX = ± 0.25" | | SHEET SIZE: B |

